

AIP HUNGARY

AIRCRAFT
PARKING/DOCKING
CHART - ICAO

BUDAPEST APP	122.975	BUDAPEST TOWER	118.100	BUDAPEST APRON	122.440
	123.860	BUDAPEST GROUND	121.910	ATIS	132.380
	119.510	BUDAPEST DELIVERY	134.540	ATIS (BUD VOR)	117.300
BUDAPEST INFORMATION (NORTH)			119.350		

BUDAPEST/LISZT FERENC
CARGO APRON

	BEARING STRENGTH
Cargo Apron	PCN 80/R/A/W/T
Taxiways: E	PCN 90/R/A/W/T
Taxiway width: 23 m.	

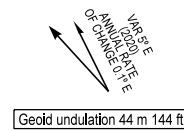

LEGEND

VISUAL AIDS

- TWY centre line light (bi-directional)
- TWY centre line light (unidirectional)
- Omnidirectional TWY edge light
- * Flood lighting

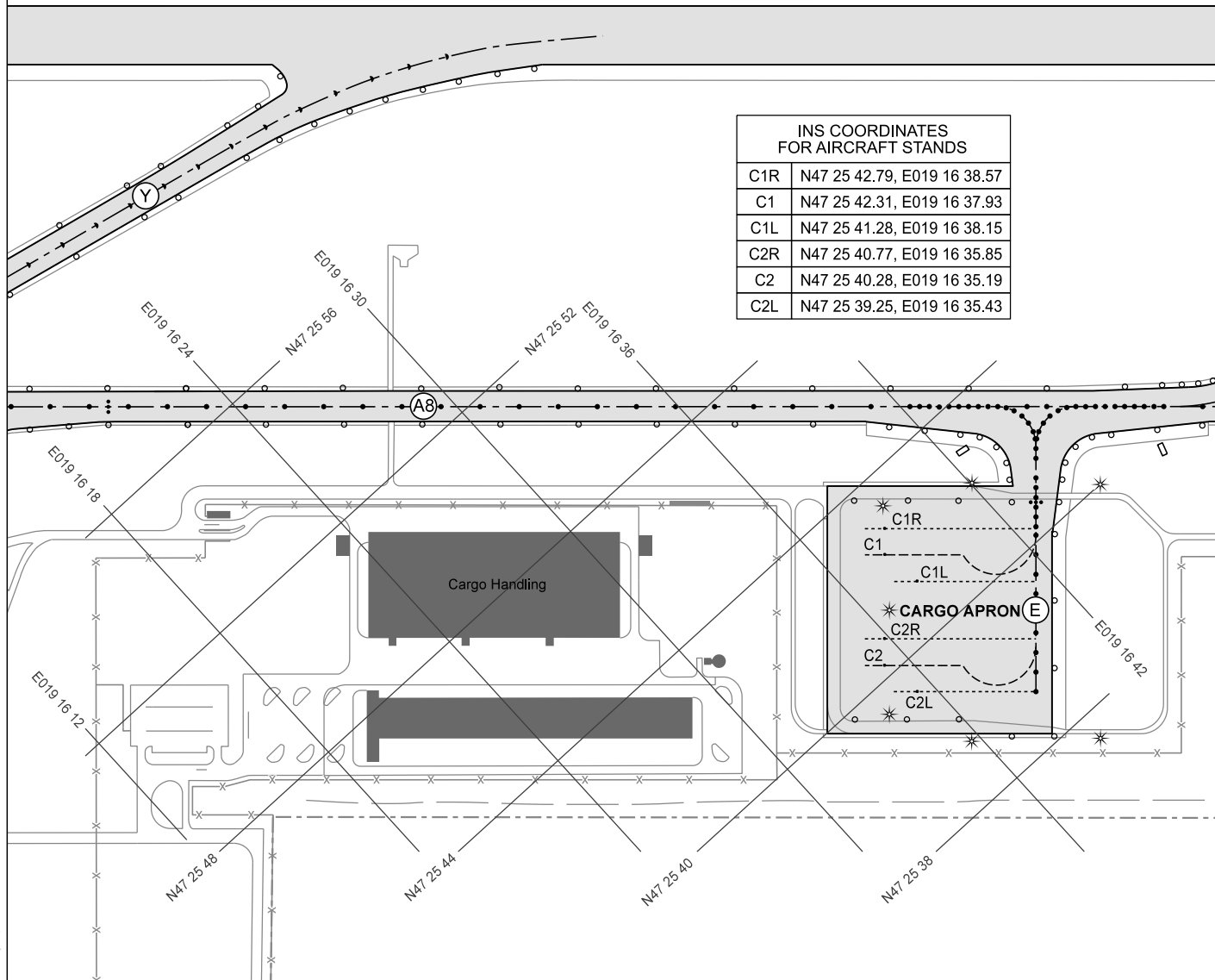

LIGHTING

TWY

Taxiway edge:	Low intensity omnidirectional blue.
Taxiway centre line:	Low intensity bi-directional green on E.
STOP bars:	Unidirectional red omnidirectional blue.
Apron:	Low intensity blue edge lights and floodlights.
Obstacle light:	Low intensity red.

FOR BASIC CHART SYMBOLS SEE: GEN 2.3.
TAXI PROCEDURES SEE: AD 2-LHBP-TAXI CHARTS.

APRON ELEVATION: NOT AVAILABLE.
GEO. COORDINATES FOR TWY CENTRE LINES: NOT AVAILABLE.
OBSTACLES TO TAXIING: NOT AVAILABLE.

ELEVATIONS ARE IN FEET
DIMENSIONS ARE IN METRES
BEARINGS ARE MAGNETIC

SCALE 1 : 5 000

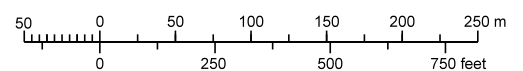

MAXIMUM PERMISSIBLE WINGSPAN ON CARGO APRON TAXIWAY

E	68.5 m
---	--------

CHANGE: BUDAPEST APRON frequency updated

THIS PAGE IS INTENTIONALLY LEFT BLANK