

| | | | | | |
|------------------------------|---------|-------------------|---------|------------------|---------|
| BUDAPEST APP | 122.975 | BUDAPEST TOWER | 118.100 | BUDAPEST APRON 1 | 131.555 |
| | 123.860 | BUDAPEST GROUND | 121.910 | | |
| | 119.510 | BUDAPEST DELIVERY | 134.540 | ATIS | 132.380 |
| BUDAPEST INFORMATION (NORTH) | | | 119.350 | ATIS (BUD VOR) | 117.300 |

BUDAPEST/LISZT FERENC
APRON AG, AA, AL

AIRCRAFT PARKING/DOCKING CHART - ICAO

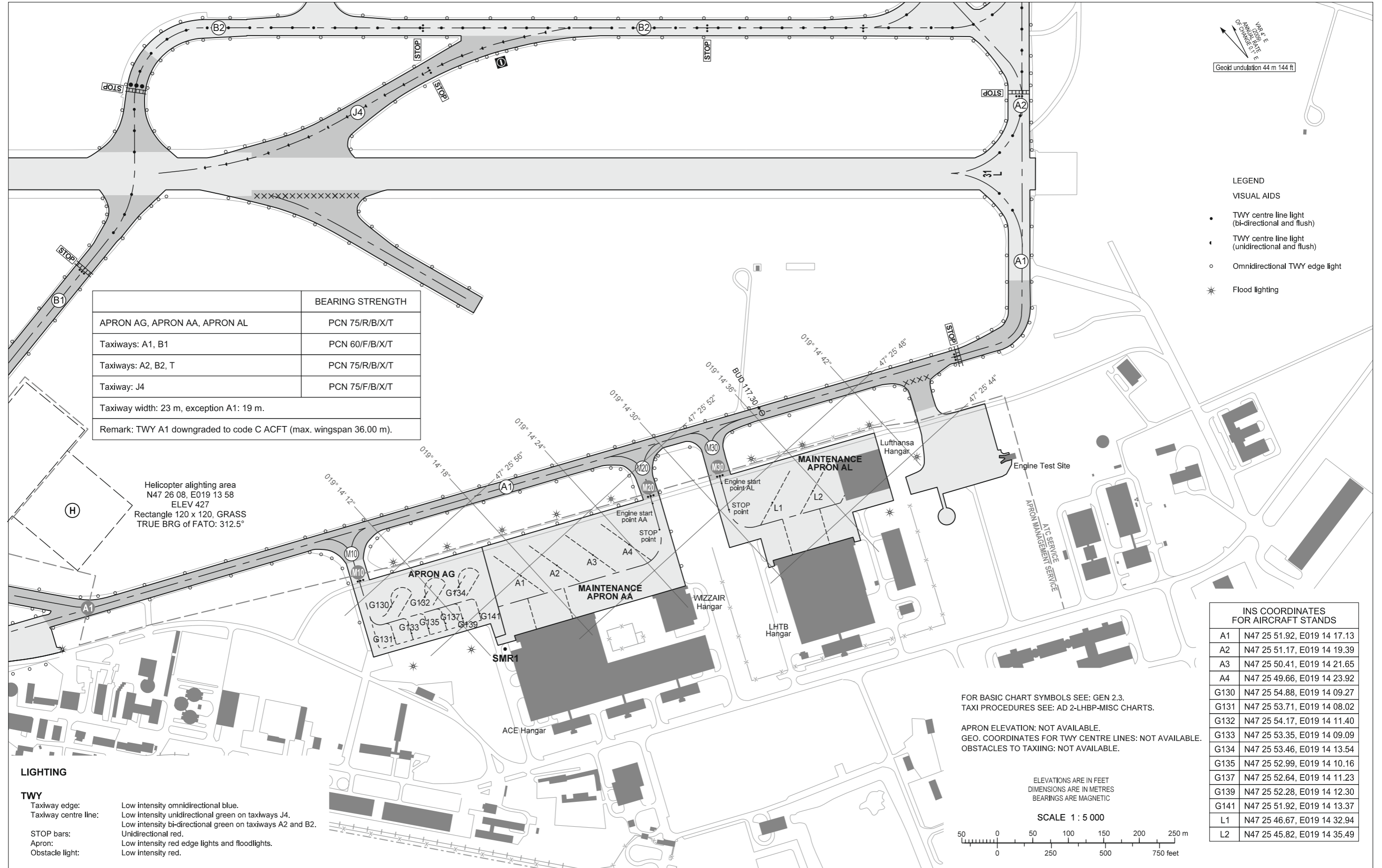

| | BEARING STRENGTH |
|---|------------------|
| APRON AG, APRON AA, APRON AL | PCN 75/R/B/X/T |
| Taxiways: A1, B1 | PCN 60/F/B/X/T |
| Taxiways: A2, B2, T | PCN 75/R/B/X/T |
| Taxiway: J4 | PCN 75/F/B/X/T |
| Taxiway width: 23 m, exception A1: 19 m. | |
| Remark: TWY A1 downgraded to code C ACFT (max. wingspan 36.00 m). | |

Helicopter alighting area
N47 26 08, E019 13 58
ELEV 427
Rectangle 120 x 120, GRASS
TRUE BRG of FATO: 312.5°

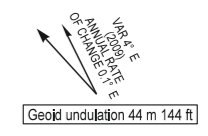

- LEGEND
VISUAL AIDS
- TWY centre line light (bi-directional and flush)
 - TWY centre line light (unidirectional and flush)
 - Omnidirectional TWY edge light
 - * Flood lighting

- LIGHTING**
- TWY**
Taxiway edge: Low intensity omnidirectional blue.
Taxiway centre line: Low intensity unidirectional green on taxiways J4. Low intensity bi-directional green on taxiways A2 and B2. Unidirectional red.
- STOP bars:
Apron: Low intensity red edge lights and floodlights.
Obstacle light: Low intensity red.

FOR BASIC CHART SYMBOLS SEE: GEN 2.3.
TAXI PROCEDURES SEE: AD 2-LHBP-MISC CHARTS.

APRON ELEVATION: NOT AVAILABLE.
GEO. COORDINATES FOR TWY CENTRE LINES: NOT AVAILABLE.
OBSTACLES TO TAXIING: NOT AVAILABLE.

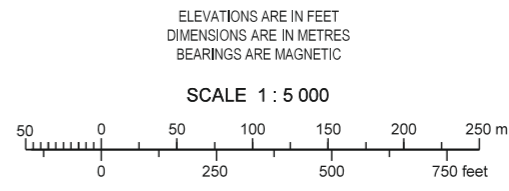

| INS COORDINATES FOR AIRCRAFT STANDS | |
|-------------------------------------|-----------------------------|
| A1 | N47 25 51.92, E019 14 17.13 |
| A2 | N47 25 51.17, E019 14 19.39 |
| A3 | N47 25 50.41, E019 14 21.65 |
| A4 | N47 25 49.66, E019 14 23.92 |
| G130 | N47 25 54.88, E019 14 09.27 |
| G131 | N47 25 53.71, E019 14 08.02 |
| G132 | N47 25 54.17, E019 14 11.40 |
| G133 | N47 25 53.35, E019 14 09.09 |
| G134 | N47 25 53.46, E019 14 13.54 |
| G135 | N47 25 52.99, E019 14 10.16 |
| G137 | N47 25 52.64, E019 14 11.23 |
| G139 | N47 25 52.28, E019 14 12.30 |
| G141 | N47 25 51.92, E019 14 13.37 |
| L1 | N47 25 46.67, E019 14 32.94 |
| L2 | N47 25 45.82, E019 14 35.49 |

THIS PAGE IS INTENTIONALLY LEFT BLANK