

AERODROME CHART - ICAO

ARP
N47 37 38
E017 48 30
AERODROME ELEV 426

PÉR INFO 129.900
BUDAPEST INFORMATION (WEST) 125.500

GYÖR/PÉR

RWY	DIRECTION	THR	BEARING STRENGTH	TORA	TODA	ASDA	LDA
12	116°	N47 37 58, E017 47 36	PCN 50/F/C/W/T	2030	2030	2130	2030
30	296°	N47 37 26, E017 49 00	PCN 50/F/C/W/T	2030	2030	2130	2030
Apron 1			PCN 45/R/C/W/T				
Apron 2			-				
Apron 3			PCN 61/R/C/W/T				
Taxiway: A			PCN 50/F/C/W/T				
Taxiway: A1, A2			PCN 44/F/C/W/U				
Taxiways: B			-				
Taxiway width: A: 15 m; A1, B: 7.5 m; A2: 10.5 m.							

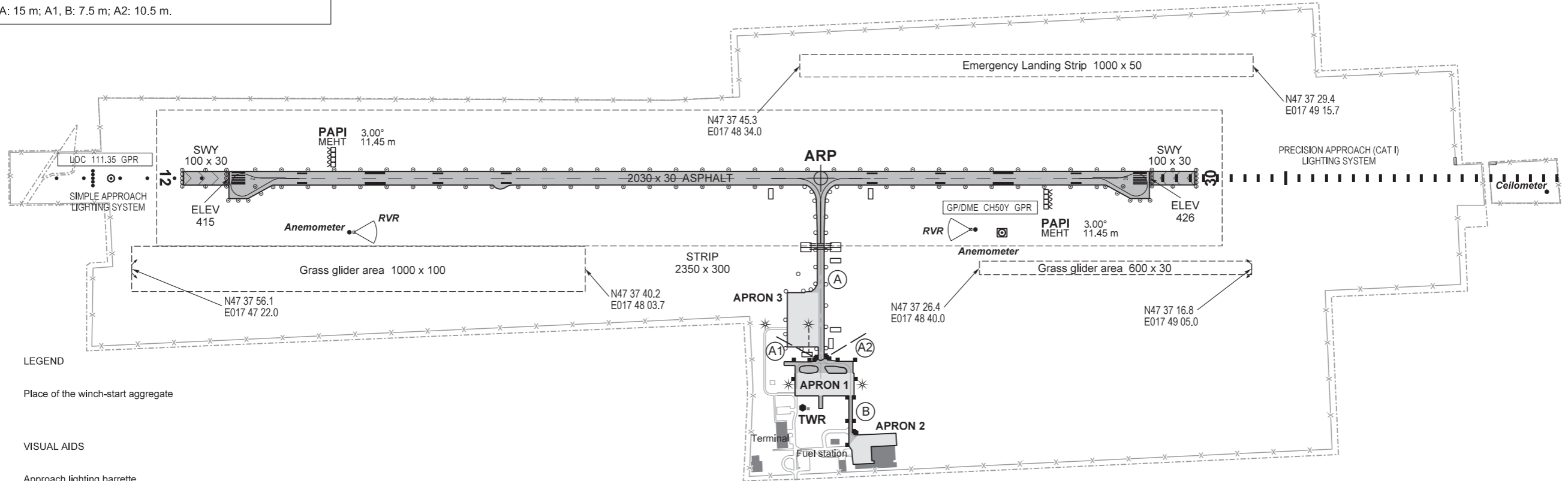
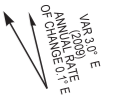

LEGEND

Place of the winch-start aggregate

VISUAL AIDS

- Approach lighting barrette
- Approach light
- PAPI
- RWY lights (edge, -threshold, -end)
- Stopway lights
- TWY edge marker
- Retroreflective TWY edge marker
- Flood lighting
- Non illuminated taxiing guidance sign

FOR BASIC CHART SYMBOLS SEE GEN 2.3.

AERODROME GUND: NOT AVAILABLE.
THR GUND: NOT AVAILABLE.
APRON ELEVATION: NOT AVAILABLE.
GEOGRAPHICAL COORDINATES FOR TWY CENTRE LINES: NOT AVAILABLE.
OBSTACLE TO TAXIING: NOT AVAILABLE.
PARKING ORDER APRON 2: NOT AVAILABLE.

LIGHTING

RWY 12/30
Approach: Cat. I, high intensity (900 m) on THR 30, SALS medium intensity (420 m) on THR 12.
Threshold: Green, 3.00° (11.45 m).
PAPI
Runway edge: High intensity white/yellow (2030 m), spacing: 58 m on THR 30, medium intensity white/yellow (2030 m), spacing: 58 m on THR 12.
Runway end: Red.
Stopway: Red (100 m).

ELEVATIONS ARE IN FEET
DIMENSIONS ARE IN METRES
BEARINGS ARE MAGNETIC

HORIZONTAL SCALE 1 : 10 000

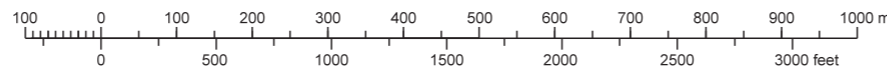

INS COORDINATES FOR AIRCRAFT STANDS	
1-7	NOT AVAILABLE

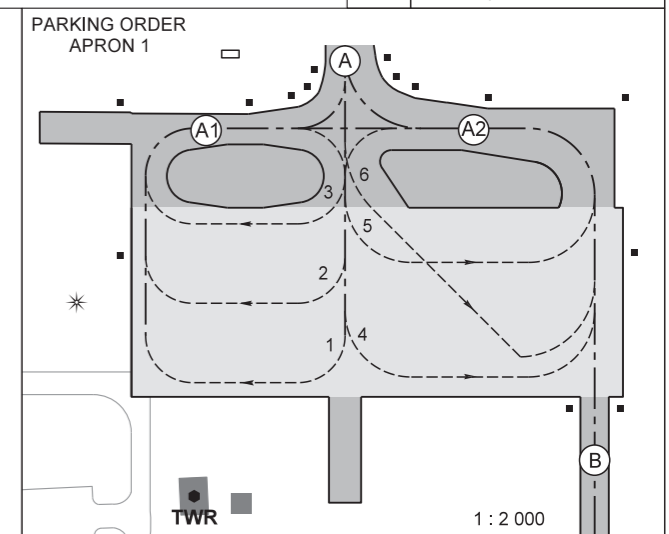
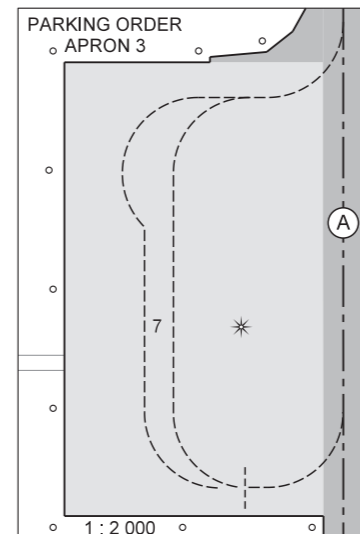

THIS PAGE IS INTENTIONALLY LEFT BLANK